

P-CN CONNECTORS

Features:

- Low insertion loss
- Low back reflection loss
- Easy to handle
- Customer defined specifications
- Environmentally stable

Applications:

- Telecommunications
- Local area network
- Fiber to the home
- Fiber optic sensors
- Testing instruments
- CATV

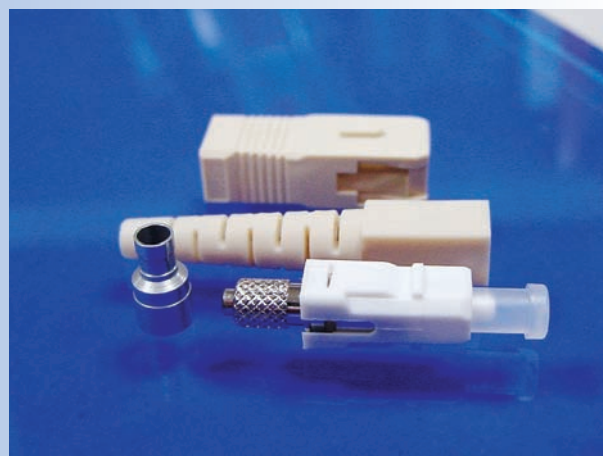

Performance Specifications:

ITEM	Connector Parts	
	Singlemode	Multimode
Mode Type		
Typical Insertion Loss, dB	0.15	0.3
Typical Return Loss(*), dB	-50	—
Operating Temperature, °C	-40 ~ +75	
Storage Temperature, °C	-55 ~ +85	

Note : * for convex polishing only

CONNECTORS

Mechanical Drawings:

Unit: mm

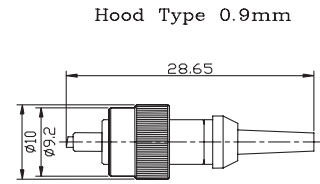
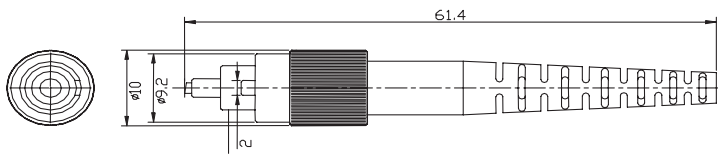

Hood Type 0.9mm

P-CN-AP- □□ - □□□□ - □ - □□

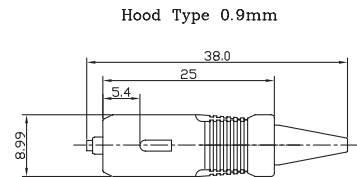
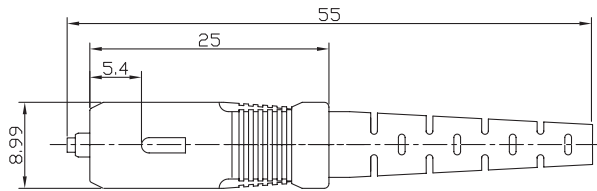
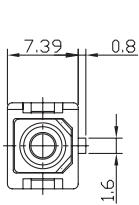

Hood Type 0.9mm

P-CN-AS- □□ - □□□□ - □ - □□

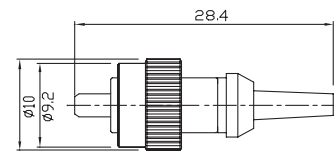
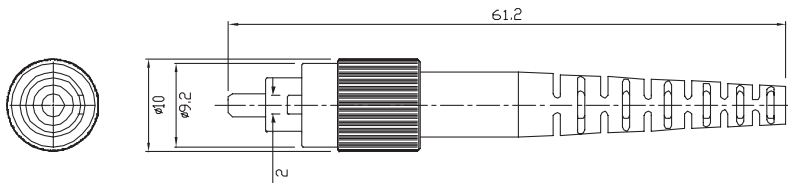

Hood Type 0.9mm

P-CN-FC- □□ - □□□□ - □ - □□

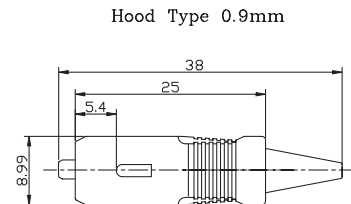
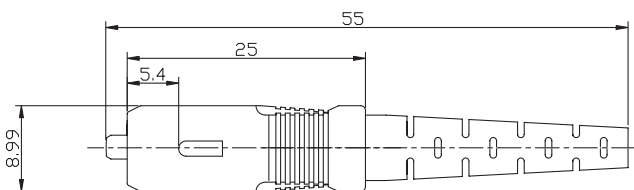
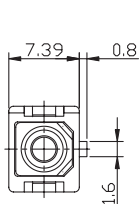

Hood Type 0.9mm

P-CN-SC- □□ - □□□□ - □ - □□

CONNECTORS

Mechanical Drawings:

Unit: mm

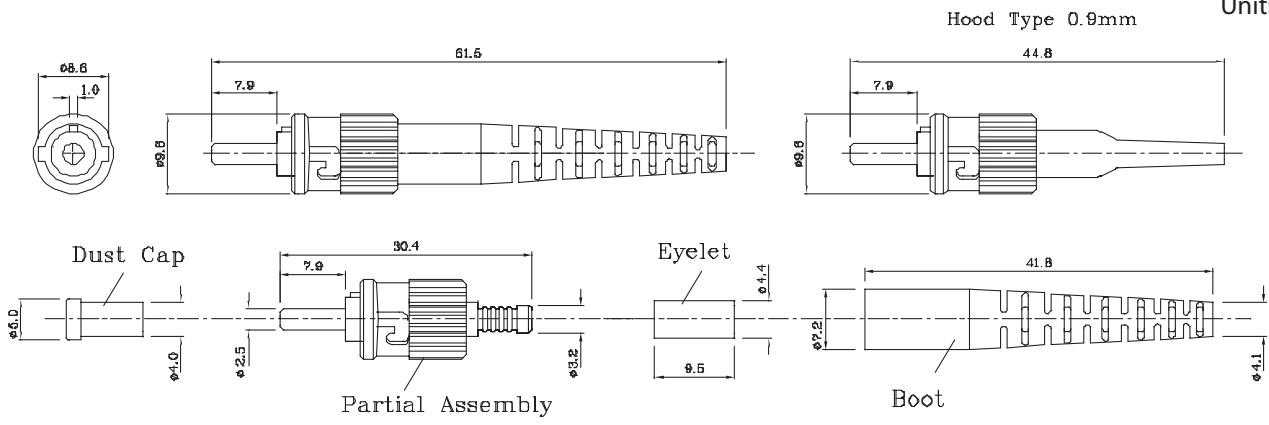

P-CN-ST-□□ - □□□ - □ - □□

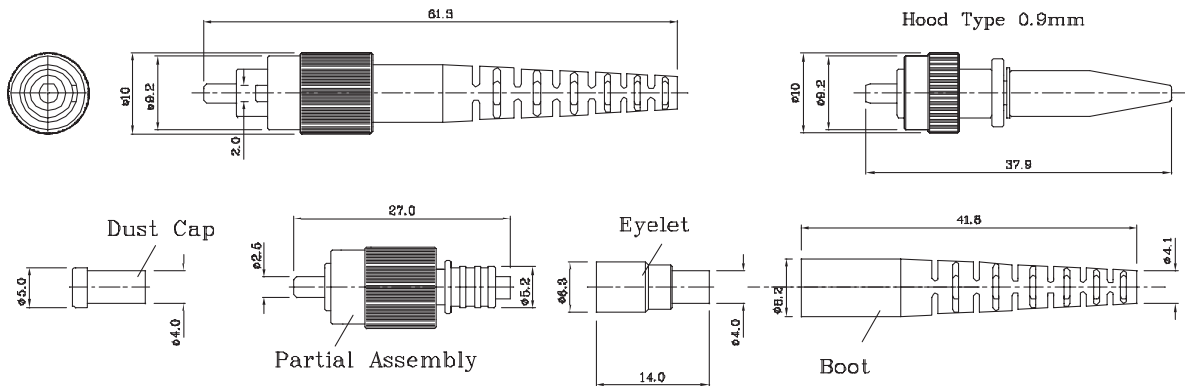

P-CN-QF-□□ - □□□ - □ - □□

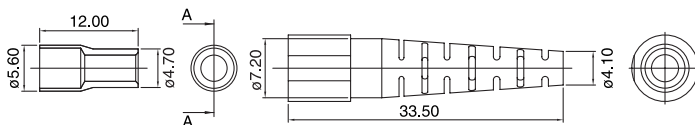
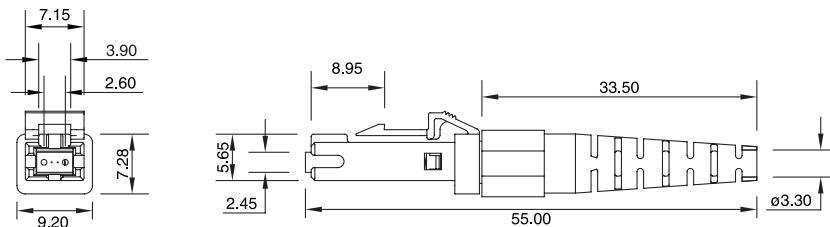

P-CN-MR-□□ - □□□ -R-□□ Crimp/boot: round (for Round cord)

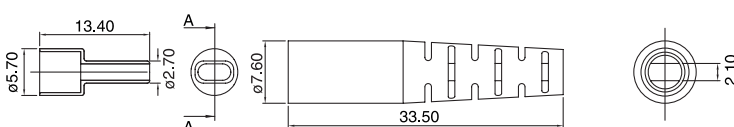

P-CN-MR-□□ - □□□ -6-□□ Crimp/boot: oval (for Zip cord)

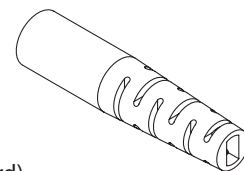
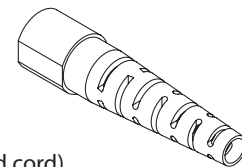

CONNECTORS

Mechanical Drawings:

Unit: mm

Hood Type 0.9mm

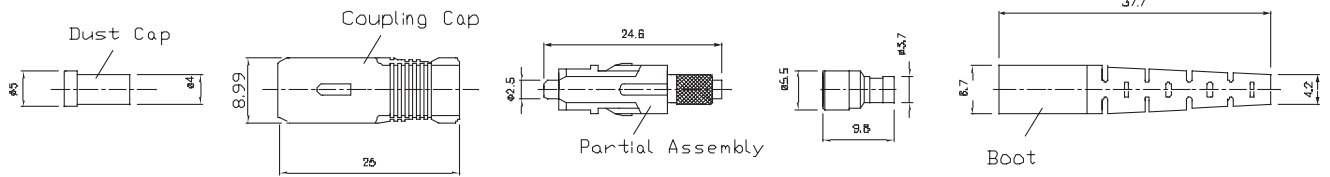
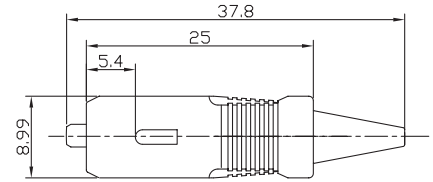
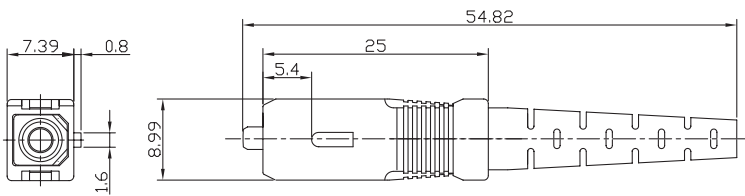

P-CN-QS- □□ - □□□□ - □ - □□

Hood Type 0.9mm

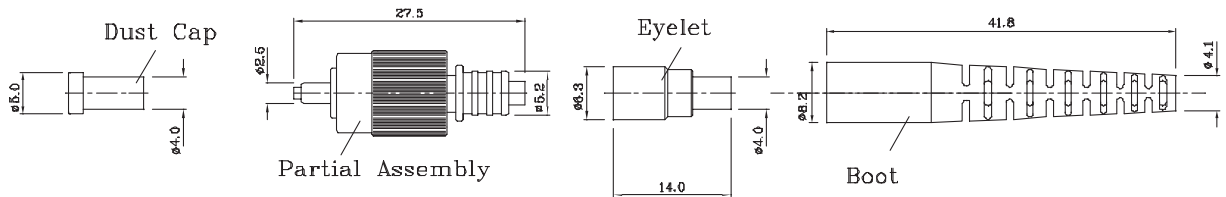
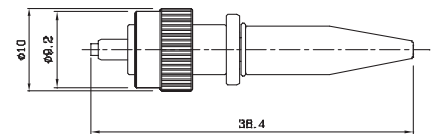
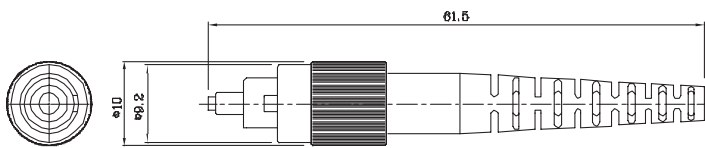

P-CN-QP- □□ - □□□□ - □ - □□

CONNECTORS

Mechanical Drawings:

Unit: mm

Hood Type 0.9mm

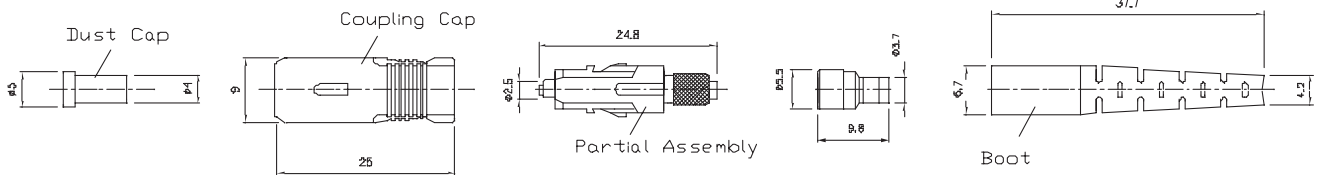
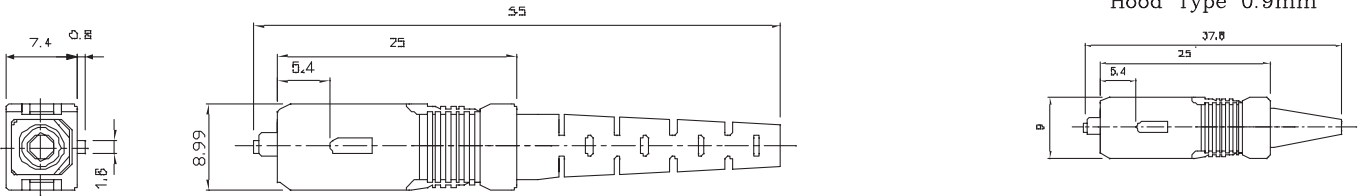

P-CN-QC- □□ - □□□ - □ - □□

Hood Type 0.9mm

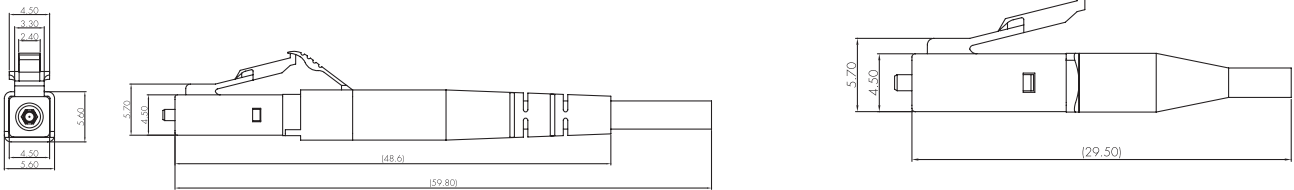

P-CN-QL- □□ - □□□ - □ - □□

Hood Type 0.9mm

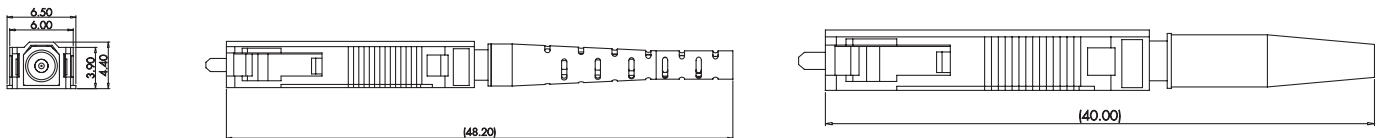

P-CN-MU- □□ - □□□ - □ - □□

CONNECTORS

Mechanical Drawings:

P - CN - - - - - -

Connector Type

- AP FC/APC type (with non-pre-Angle, Step Ferrule)
- AS SC/APC type (with non-pre-Angle, Step Ferrule)
- FC FC type
- SC SC type
- S2 SC2 type
- QF Quick assembly FC type
- QS Quick assembly SC type
- QP Quick assembly FC/APC type (with non-pre-Angle Step Ferrule)
- QC Quick assembly SC/APC type (with non-pre-Angle Step Ferrule)
- QL Quick assembly LC type
- ST ST type
- LC LC simplex type
- DL duplex quick assembly LC type
- MU MU simplex type
- DM MU duplex type
- MR MTRJ Female
- MS MTRJ Male
- XX Others, please specify

Ferrule Material

- M Metal
- C Ceramic (Zirconia)
- P Plastic
- X Others, please specify

Mode Type

- S Singlemode
- M Multimode

Ferrule Inner Diameter

- 125 125µm
- 126 126µm
- 127 127µm
- 12h 125.5µm
- XXX Others, please specify

Hood Type

- | | | | | | |
|---|-------|---|----------------------------|---|-------------------------------|
| 1 | 0.9mm | 2 | 2.4mm | 6 | 3.0mm (MTRJ-oval crimp/boot) |
| 3 | 3.0mm | 4 | 3.0mm (Strain relief boot) | R | 3.0mm (MTRJ-round crimp/boot) |
| 5 | 2.0mm | | | | |

Hood Color

- BL Black
- GN Green
- BU Blue
- RE Red
- BG Beige
- WH White
- XX Others, please specify